

MITRE 10

Landscaping Guide

Transform your outdoor space this summer.





Landscaping is the art of laying out grounds

We landscape and garden to create a beautiful environment that adds both privacy and pleasing combinations of form, colour and shade to your outdoor living areas. The garden is an extension of your home - a place to relax, play, work, dine and entertain.

Landscaping starts with deciding how you intend to use the space, followed by careful assessment of the site and development of a plan. Design your outdoor space to complement the style of your house, and keep in mind that all the different parts of the garden - the lawn, paths, paving, decking, borders, plants and trees - must work together to form a pleasing whole.

At Mitre 10 we have an extensive range of products to help you transform your outdoor space from ordinary to something exceptional and personalised. Our team members are ready to help you with your planning and product selection and will be here through your entire project.

For more information or inspiration to help you plan your landscaping project, visit mitre10.co.nz/easyas or chat with the team in-store.





Radiata Decking

Kiwi love the outdoors and a deck is a popular addition to the home. At Mitre 10 we can guide you through the process step by step, so you can get the job done right and design a deck that'll last for years. So, whether you're tackling a small-scale project or something more substantial, we're here to help you find the right decking for your outdoor space.

PREMIUM GRADE DECKING

- This decking option is manufactured to a premium grade, and will create a classic look at an affordable price. It is available with a reeded profile or smooth on both sides.
- Sizes available 90x21mm, 90x32mm or 140x32mm
- H3.2 treated radiata
- Merch grade decking also available.



ENGINEERED SOLID WOOD DECKING

Key Deck is a NZ grown, engineered, solid wood decking which is then put through an oil and colour infusion process.

- Barefoot friendly
- Quartersawn for stability
- Comes in 3 pre-finished colours, Antique Grey, Natural Amber and Highland Copper.
- FSC certified
- Sizes available 90 x 21mm, 90 x 32mm or 110 x 21mm

Deck Stains & Oils

Staining your deck not only makes your deck look great, but it protects the natural timber from the harsh New Zealand sunshine and weather.



Handy hints

For a new deck, make sure your deck has been weathered for a season before applying any stain.

WATTYL FORESTWOOD PRODECK OIL

Prodeck Oil offers results that last up to three times longer than traditional decking oils and can be applied up to three times faster, plus get three-way protection against moisture, UV Light, mould and fungus.



WATTYL FORESTWOOD AQUATECH DECKING OIL

A low odour, waterbased decking oil that produces a rich, transparent finish in desired timber tones without hiding the natural timber grain.



WATTYL FORESTWOOD DECK AND FURNITURE OIL

Highlights the natural grain, colour and texture of timber and is versatile and easy to apply. Its oil based formula is resistant to fungus and mould and is suitable for most decking and garden furniture timbers.



WATTYL FORESTWOOD DECK AND TIMBER STAIN

A low-odour, water based stain that applies easily and dries quickly. It is water repellent, provides UV protection and resists mould and fungus. Use on decks, steps, pergolas, windows, gates and outdoor furniture.



Hardwood Decking

If you are looking to create a social space that is both stylish and durable, Mitre 10 has a range of premium quality hardwood decking. Species such as Kwila, Vitex, and Garapa will provide an attractive, yet hard-wearing decking material.

KWILA DECKING*

- Kwila is a deep red-brown colour with a distinct golden fleck in the heartwood. It is hard and heavy and is considered a benchmark when building a hardwood deck.
- Sizes available 90x19mm & 140x19mm
- Sourced from approved sustainable sources
- Finger jointed lengths available



VITEX DECKING*

- Vitex produces a creamy grey heartwood with a fine even texture and a banded or striped pattern. It is easy to work with and has proven popular throughout New Zealand.
- Sizes available 90x19mm & 140x19mm
- Smooth on both sides
- Special order product. Order through your local store



GARAPA DECKING*

- Garapa is light yellow to honey-brown in colour with an interlocked grain and fine texture. It is a durable timber that resists rot and decay making it a great decking option.
- Sizes available 90x21mm & 140x19mm.
- Smooth on both sides
- Sourced from approved sustainable sources
- Special order product. Order through your local store



**Products featured may not be stocked in all Mitre 10 stores but can easily be ordered in for you.*

Composite Decking

Composite decking boards are made from a mix of timber fibres and recycled plastics. It has the look and feel of a traditional timber deck, with the added strength and durability of a composite material making it an eco-friendly alternative.

BENEFITS OF COMPOSITE DECKING

- Low maintenance
- No need to stain or oil
- Hard wearing
- Long lasting
- Less likely to crack, rot or split
- Hidden fixing system
- Splinter free
- Slip resistant



TIMBERTECH HARVEST COLLECTION

Enhance your outdoor living space with the nature-inspired TimberTech Harvest Collection. This capped polymer decking is made from PVC making your deck resistant to mould while providing better slip protection. These boards are wider in size and deliver natural wood grain aesthetics that amplifies elegance and style. Every board contains up to 50% of recycled PVC material creating an ideal sustainable solution. With its unique composition, it allows you to feel up to 30% cooler compared to many other composite decking products and have peace of mind with an industry-leading warranty of 50 years. So, trust the TimberTech Harvest Collection to leave your deck looking good for decades to come.

Board size: 184mm x 24mm x 4.8m and 6m lengths. Available in Slate Grey as shown



Eva-Last®'s range of composite decking solutions offer premium outdoor living through innovative, durable, and eco-friendly products. The Eva-Last® range pairs recycled raw materials with bamboo for a stronger, more sustainable composite decking option.

- FSC bamboo composite decking
- Available in 4 natural colours
- Slip resistant
- Moisture resistant
- UV resistant
- 25 year warranty



Decking Screws

You can use either nails or screws to fasten Radiata or Hardwood decking. When using screws always pre-drill your decking and use a screw that is at least 40mm longer than the thickness of the decking you're using.



Choose the right OTTER screw for your outdoor project

WIDE BOY (LARGE HEAD) DECK SCREWS



- 'Wide Boy' Countersunk Head - Square Drive - Type 17 Point - ChemShield*
- Stainless Steel 304
10G x 50 & 65mm

SOFTWOOD COUNTERSUNK DECK SCREWS



Designed for fixing softwood decking.
- Countersunk Head - Square Drive - Type 17 Point - Stainless Steel 316
7G x 65mm

HARDWOOD COUNTERSUNK DECK SCREWS

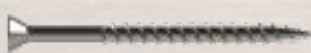

Designed for fixing hardwood decking.
- Countersunk Head - Square Drive - Type 17 Point - Stainless Steel 302 - Stainless Steel 316
SS302 - 8G x 50 & 65mm & 10G x 50 & 65mm
SS316 - 10G x 50 & 65mm

TREATED PINE COUNTERSUNK DECK SCREWS



Designed for treated pine decking.
- Countersunk Head - Square Drive - Type 17 Point - ChemShield®
8G x 50 & 65mm
10G x 50, 65, 75, 100 & 125mm

HARDWOOD TRUSS DECK SCREWS



Designed for hardwood decking.
- Truss Head - Square Drive - Cross Point - Self-drilling - ChemShield®
- Stainless Steel 316
CHEM- 10G x 50 & 63mm, SS316 - 10G x 50 & 63mm

HARDWOOD COUNTERSUNK DECK SCREWS

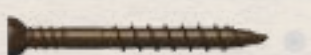

Designed for hardwood decking.
- Countersunk Head - D25 Drive - Cross Point - Self-drilling - ChemShield®
- Stainless Steel 316
CHEM- 10G x 50 & 63mm, SS316 - 10G x 50 & 63mm

FINISH

- CHEMSHIELD® coating provides corrosion resistance in treated timbers.
- Stainless Steel 302/304 provides resistance in salt-spray zones.
- Stainless Steel 316 provides marine and industrial grade protection.

TIP

- Pre-drill timber ends to prevent splitting.
- Use Otter Deck Spacers for accurate and professional spacing between decking and outdoor screens.

HEAD TYPE

COUNTERSUNK HEAD

A trim head designed to sit level with or just below the surface of the timber for minimum visual impact. The 'Wide Boy' has a larger head profile for visual impact and maximum holding power.

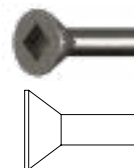

TRUSS HEAD

Low profile dome shaped head with flat sharp edge designed to cut through timber fiber as it self countersinks.

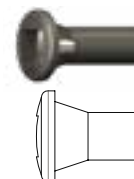

DRIVE TYPE

SQUARE DRIVE

A square shaped recess that reduces cam out under load providing a positive connection for high torque applications.



D25 DRIVE

A star shaped recess with a series of ribs providing maximum surface contact between the driver and screw for high torque applications.



POINT TYPE

CROSS POINT

A patented self drilling point with special crossed threads at the tip that drill and mulch the timber fibres to the surface as it is screwed in.



TYPE 17 POINT

A special long sharp self-drilling point with a flute that cuts the timber fibres as it is screwed in. Timber fibres are collected in the flute and reduces the potential for splitting.



TOOLS

2-IN-1 DRILLING & COUNTERSINKING BIT

Depth adjustable. Includes hex key and replaceable bit. 2 sizes available to suit most 6-8 or 10-12 gauge screws.



Paving

Paving is a convenient, affordable way to add value to your home. The combination of shapes, patterns and colours available, make paving an attractive choice for both new homes and improvements to existing homes. With a little planning and preparation, even large areas can be paved to a high standard by the DIY enthusiast.



FIRTH DESIGNER SERIES

The Firth 'Designer Series' is an inspiring residential paving range created especially for consumers seeking a high-end look and feel, supported with the highest quality in dry cast paving. They are honed to reveal the aggregate within.

- Avon, Raglan Sands, Milford Sound, Paihia.

FORUM PAVERS

These hard-wearing and impressive pavers provide homeowners with a perfectly integrated, natural, stone-looking hardscape. Forum® dimensions, are twice the size of the Piazza®

- 400L x 400W x 50D mm, 6.25 units per m²
- Black Sands, Glacier, Volcanic Ash, Sumner

PIAZZA PAVERS

The Piazza® Paver can be mixed and matched with other Forum and Holland pavers (both colours and sizes) to create your very own unique design.

- 400L x 200W x 50D mm, 12.5 units per m²
- Black Sands, Glacier, Volcanic Ash, Sumner



The appeal of concrete paving and retaining products is the natural characteristics and variation of aggregates featured within the mix. Please expect colour hue variations and regional differences due to locally sourced materials. It's all part of the beautifully natural product.

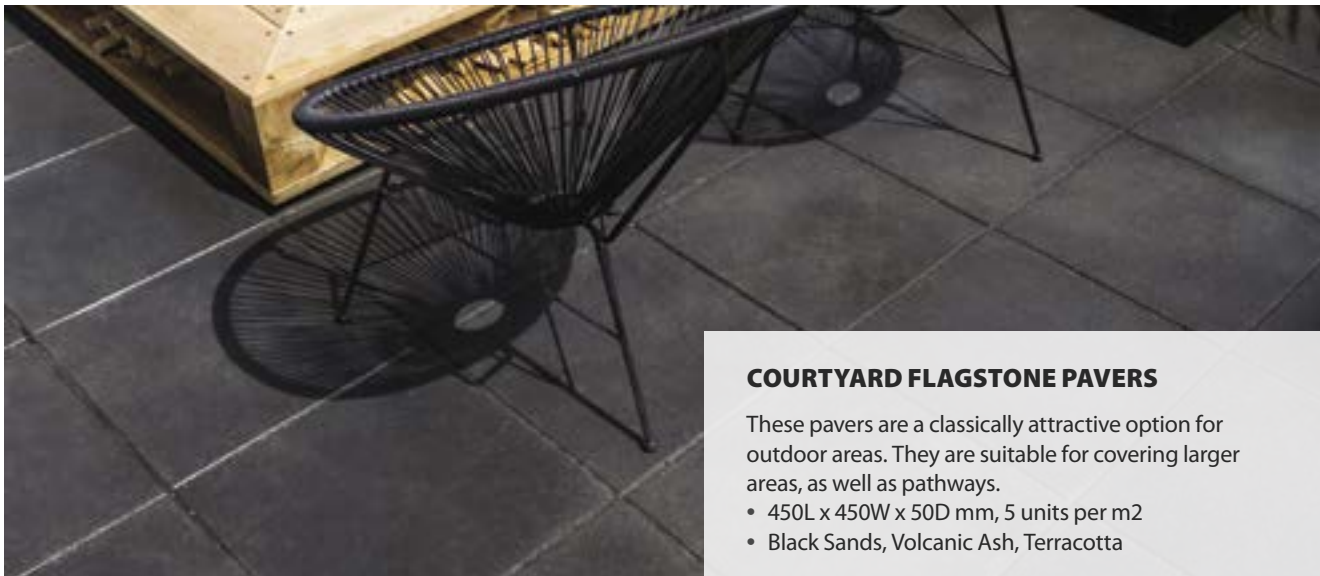

COURTYARD FLAGSTONE PAVERS

These pavers are a classically attractive option for outdoor areas. They are suitable for covering larger areas, as well as pathways.

- 450L x 450W x 50D mm, 5 units per m²
- Black Sands, Volcanic Ash, Terracotta



HOLLAND PAVERS

The economical and highly versatile Holland® pavers offer a hard-wearing solution for any footpath or patio. Pair with Forum® or Piazza® pavers to create interest with striking patterns.

- 200L x 100W x 50D mm, 50 units per m²
- Black Sands, Terracotta, Volcanic Ash, Sumner



WALKWAY™ PAVERS

With their traditional look, Firth Walkway pavers are an economical and good looking option for paving different areas around your home.

- 230L x 190W x 50D mm, 23 units per m²
- Black Sands, Terracotta, Volcanic Ash, Sumner

Paving Laying Patterns

It's important to think about the laying pattern you want as this is just as important as the choice of colour, size and texture. Patterns and fixed edging create the strength in your pathway or driveway. They prevent paving becoming loose and spreading, particularly on driveways where vehicles are turning and tyres are putting strain on the individual pavers.

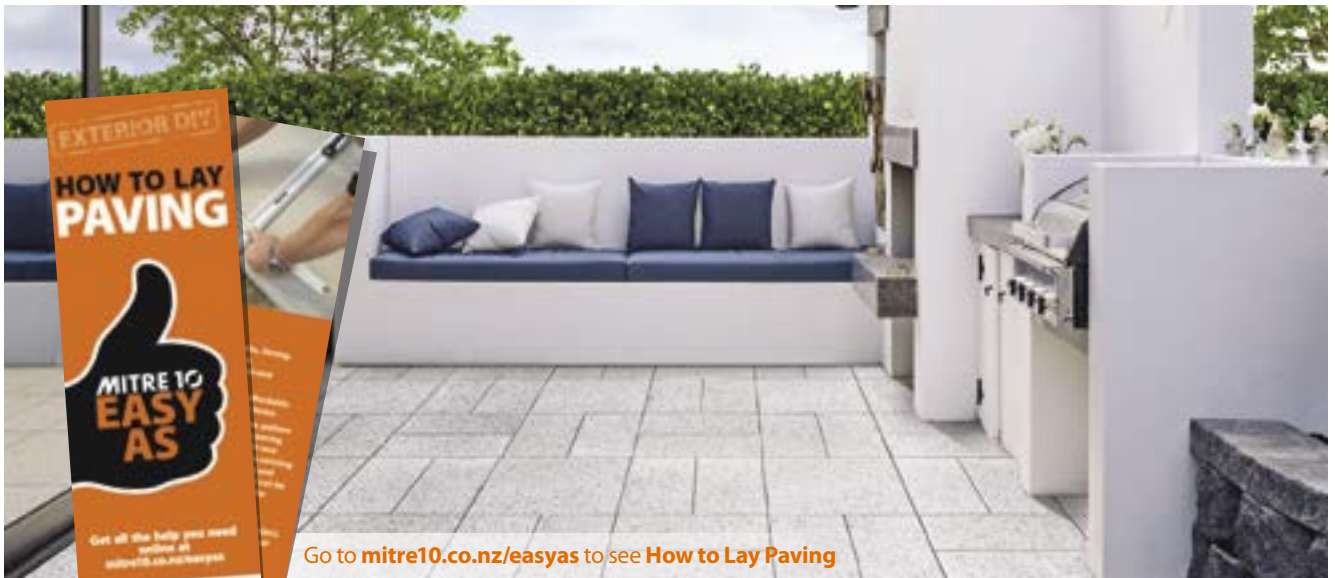

Go to mitre10.co.nz/easypav to see **How to Lay Paving**



FIRTH LAYING PATTERNS

Firth concrete pavers are designed to be used interchangeably to create designer landscapes. By mixing different sizes and colours you can create your own laying pattern to suit your space.



Handy hints

Add interest to your paving by laying a "soldier course" and/or "chaser course". A chaser course is a row of pavers, usually of a contrasting colour, laid in the opposite direction immediately inside the soldier course.

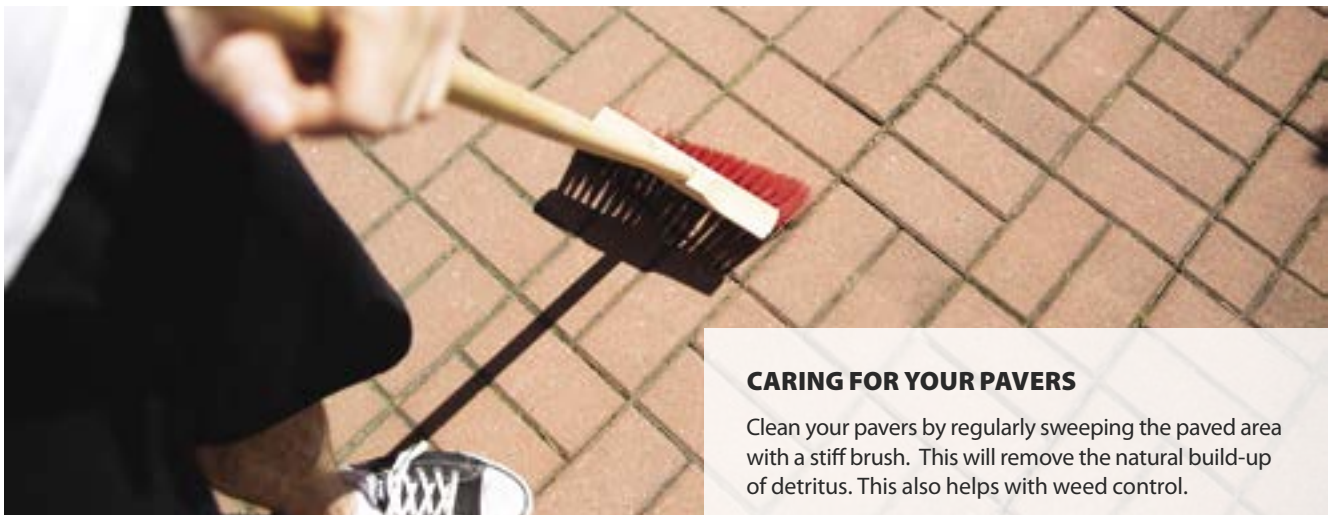

CARING FOR YOUR PAVERS

Clean your pavers by regularly sweeping the paved area with a stiff brush. This will remove the natural build-up of detritus. This also helps with weed control.

Natural Stone Paving

Natural stone paving is hard wearing and offers a different texture and colour to traditional concrete paving. We have a variety of bluestone, cobblestone, granite and sandstone options available.



INDIAN SANDSTONE

Urban Paving's range of handcrafted Indian sandstone is sourced from the highest quality mines in India. Each individual paving stone is unique in both texture and colour. Indian sandstone presents a harmonious blend of subtle natural tones within a controlled colour palette. Using this product in your outdoor area introduces quality and longevity, showcasing the warming rays of the sun-baked Indian quarries where this beautiful soft stone is at home. Available in 5 unique and natural sandstone colours and textures: Cloud (natural split), Tawera (blasted), Walnut, Pearl (honed) and Pipi (natural split and honed).

BLUESTONE

Urban Paving honed bluestone paving is unique in both colour and texture, sourced from the highest quality-controlled quarries in China. The honed texture of the stone provides a contemporary feel while still retaining its natural charm and character, including the honeycomb veins that run through the stone. Being a natural product, bluestone pavers are also extremely hard-wearing and easy to maintain. These pavers are available in a variety of sizes and shapes, including regular, drop face and bullnose.



GRANITE

Urban Paving granite pavers are a stunning part of their natural stone range, featuring the flamed texture of the natural stone. Sourced from the highest quality-controlled quarries in China. Granite paving is unique in both colour and texture, to create a modern look while still retaining its individual character. Black, grey and white flamed granite pavers are available in a variety of sizes and shapes, including regular, drop face and bullnose. Please note that black granite can have some hairline cracks (approximately 15%). This is part of the nature of granite being a natural stone and does not affect the structural integrity, sealing will partially conceal these cracks.



Pergola Laminated Posts & Beams

A pergola may be built freestanding or attached to your house and can add function and visual interest to your outdoor area.



By using laminated posts and beams for your project you will add strength and stability that will last the test of time, as well as producing a high quality finish.

- Available in a range of sizes and lengths to suit your project.
- Easy to paint or stain.
- Special order product. Order through your local store.

Go to mitre10.co.nz/easyas to see **How to Build a Pergola**



Image courtesy of Prodam

Deck Joist Tie

SIMPSON STRONG-TIE Add beauty and strength to your pergola

Simpson Strong-Tie offer a range of decorative timber connectors and fasteners that bring both design elegance and structural strength to your outdoor living areas.

- Accommodates 90mm and 140mm timber sizes
- Tested to resist wind and seismic loads
- Galvanised steel with a black powder-coat finish
- Easy installation



Strap Tie



Heavy Duty Angle

i Handy hints

Before you get into it, there are a few important things you need to know. While you don't actually need a building permit, you still have to adhere to building regulations. You'll need to get a Licensed Building Practitioner (LBP) to draw up some plans to help you make sure you're doing it right and using the correct materials.

When drawing up your plans with your LBP, there are a few things to consider.

- You want to make the beam high enough so it doesn't obscure your view from inside.
- You want to build it so it's in keeping with the overall style of your house.
- If you want to put a roof on your pergola, then it'll need to be under 20 square meters, and you'll need to design it with a fall so water can run off it.

PVC & Polycarbonate Roofing

A pergola can add some real character to your backyard, creating a pleasant shady space to relax. You can get more shelter from the weather by installing corrugated PVC or polycarbonate roofing.



PVC ROOFING

Suncall and Sunclear PVC Roofing are low-cost, translucent roofing options ideal for use around the home. Suncall corrugated sheets have a unique embossed surface which gently and evenly diffuses natural light, reducing the glare from direct sunlight. Sunclear corrugated PVC sheeting is clear, which allows natural light to be used in places where you still require the light of day, such as pergolas, windbreaks, and carports.

Lengths available: 1.8, 2.4, 3.0 and 3.6 metres

Colour available: Clear



POLYCARBONATE ROOFING

Solasafe corrugated polycarbonate sheeting provides 99.9% protection from the harmful UV rays that cause sunburn and skin damage. Used as roofing or screens, Solasafe polycarbonate corrugated sheeting can help you create an outdoor living area in your home so your family can safely enjoy the New Zealand lifestyle. It will also add value to your property. Solasafe is fade resistant, will not be damaged by normal hail and easy to handle and install, making it ideal for high end decking solutions.

Lengths available: 1.8 meters - 6 metres

Colours available: Clear, Grey, Bronze and Opal.

Go to mitre10.co.nz/easyas to see **How to Install Corrugated Polycarbonate Roofing**

Timber Fencing

Building a fence is the easiest way to give your property some extra safety, security, and privacy, as well as helping to reduce noise. Whether it is a simple post, rail and paling fence or a classic picket fence, Mitre 10 has everything you need to get it done.



Handy hints

You can build a fence up to 2.5m high without a permit, but it's always best to check with your council before starting. If building on a boundary, you'll need to determine exact locations of boundary lines then talk to your neighbour about the style, costs, and start time. Downloading a copy of the "Fencing Act" may help with these discussions.

Go to mitre10.co.nz/easyas to see **How to Build a Fence**

Fence Post

- 100x100mm
- H4 treated radiata
- Lengths available are 1.8, 2.1, 2.4, 2.7, 3m



Fence Rail

- 100x50mm
- H3.2 treated radiata



Fence Paling

- Sizes available are 150 x 19mm, 150 x 25mm
- H3.2 treated radiata
- Lengths available are 1.2, 1.5, 1.8m





Premium Grade SG8 Posts

These premium posts are dressed and arissed for a smooth clean finish that make them an ideal choice for quality fences, verandas and pergolas.

- Solid radiata 88 x 88mm posts
- Premium grade ex-pruned logs for maximum clear wood quality
- SG8 rated structural grade strength
- H4 CCA treated for in-ground use
- Kiln dried after treatment to ensure stability
- Individually wrapped for protection
- Available as 1.8m, 2.4m, 3m or 3.6m lengths



Dressed Fence Posts and Palings

When a better finish is required opt for a dressed post and paling. The smoother finish makes it easier to paint and handle.



Guardian Fencing Systems

Guardian Fencing offers you high quality vinyl, aluminium and glass fencing & balustrade systems. Only the best quality materials are used combined with high levels of workmanship. All aluminium and glass systems are tested and comply with the appropriate New Zealand standards.



VINYL FENCING

Guardian Horizon Vinyl Fencing range offers a long lasting classic and modern look to perfectly finish any property. 100% virgin vinyl with zero maintenance required is bringing a new generation of fencing material, which will look as good in years to come as the day it was put up. With 3 styles that can easily complement more traditional weatherboard villas or stylish architectural properties, this easy to assemble range has all your options covered. UV and weather protected to ensure it stands up to the harsh New Zealand climate.

Styles available: Privacy, Picket Privacy and Semi-Privacy.

Lightweight and easy to install, this system will take hours off your labour bill compared to generic installation of a timber fence, with the added benefit of walking away once installed. No painting is required to achieve the sleek white finish.

FENCING KITS

The full range of Guardian fencing system products are available at Mitre 10. This includes panels, posts, gates, post caps, spigots and hardware, we have everything you need to get the job done right. The convenience of a fencing kit makes it a great DIY project as they are relatively easy to put together. The variety of different fencing kit styles available means we have something to suit every space.



GLASS FENCING

The Guardian Glass Fencing and Balustrade range provides a modern, architecturally designed modular system that will add a contemporary and sophisticated look to your home. Complying to New Zealand safety standards and accessories made from superior grade stainless steel. The Guardian Glass Fencing systems are made to stand the test of time.



ALUMINIUM FENCING

Aluminium fencing gates and accessories provide affordable solutions that are simple, stylish and cost effective ways to add value to your property. Mitre 10 offers an extensive range of standard sizes and varied designs to suit and home perimeter, balustrade, or pool fencing needs.

Guardian Fencing Systems

Guardian Fencing offers you high quality vinyl, aluminium and glass fencing & balustrade systems. Only the best quality materials are used combined with high levels of workmanship. All aluminium and glass systems are tested and comply with the appropriate New Zealand standards.



BATTEN FENCE

The Batten fencing range from Guardian comes in both black and white rust-free powder coated aluminium. The sleek design brings a modern element to any outdoor space, while also being a very practical solution. The narrow spacing between battens makes it a great fencing option to keep small pets within boundaries.



SLAT FENCE

Slat fencing provides great privacy as a fencing option, whilst also having a sleek and modern design. The Guardian slat fencing panels are 1750mm high, and available in 900mm and 1800mm wide options. They are great for hiding unsightly pool equipment, rubbish bins or air conditioning units.



PICKET FENCE

Guardian's Aluminium Picket Fence Panel is a modern and lasting alternative to wooden picket fencing. This perimeter fence panel is 2400 x 1000mm in size and constructed with strong and rust-free aluminium for enhanced durability. With no painting or maintenance required, it's a simpler and faster to install option than traditional picket fencing.

XPRESS Fence

The XPRESS Fence system from PSP is a modular aluminium fencing kit. The simple push together system makes it quick to install with no welding or screwing required. You can customize this with the use of timber or composite slats, or the standard aluminium slats.



Hebel PowerFence

Masonry fencing is very durable and provides a great privacy and noise barrier. The Hebel PowerFence system consists of lightweight AAC panels, and is available through Mitre 10.



HEBEL POWERFENCE

Hebel PowerFence is a versatile fence system that provides an efficient and effective privacy and noise barrier for residential applications. Perfect for boundary fencing and low front walls, Hebel PowerFence uses a modular masonry structure of lightweight autoclaved aerated concrete panels and steel posts. It is a very customizable system, it can be rendered or painted to suit any home design, and can be finished with expressed joints or a monolithic look.

Fentec Fencing Systems

Fentec specialize in providing high quality fence and gate systems that will enhance the value and safety of your property. Fentec have a wide range of fencing systems available in a range of colours, different styles, and options made from aluminium, steel, and timber.



EASYWALL

EasyWall is a superior slim profile fence option that will stay straight and true, preventing twisting and warping over time. It combines the strength of steel posts and rails with the beauty of cross-laminated timber planks to create a solid fence that will add an element of privacy to your outdoor space. Quick and easy to install, EasyWall is also the same-both-sides, meaning both neighbours get the good side.



COLOURWALL

This fencing option is ideal for residential properties because it is durable and stable, and both neighbours get the good side of the fence. Colourwall is quick and easy to install, There are a range of different options available with Colourwall, you can achieve both a solid fence, or add a slat top option. Available through Mitre 10 in 4 different colours.



MANSION

The Mansion fence is modern, sleek, and extra-strong making it a popular choice for swimming pools, front fences, childcare, and commercial applications. The Mansion fencing range comes in three standard heights with matching pedestrian gates and driveway gates for a complete solution. With a double top rail and square vertical bars, this panel is perfect for both residential and commercial applications. Mansion fencing is Aluminium so will not rust or corrode, and is powder coated satin black.



RAKING

The Raking Panel is the perfect solution for fencing on hills or sloped properties. This option is quite different from our other fencing panels available and is part of the Delta fencing range. The key feature of the raking panel is that the vertical pickets pivot inside the top & bottom rails meaning the panel can rake anywhere from 0 degrees (flat) to 45 degrees. The Delta fencing and raking range is made of high-quality aluminium, making it both strong and durable, yet light in weight. Delta fencing is suitable for residential landscape fencing, swimming pool fencing, and school safety applications. The delta range also includes standard vertical panels, single and double gates, balustrade panels, which can be combined with other accessories to customise how it looks in your outdoor space.

Gates & Picket Fencing

A gate can finish off a fence nicely, as well as giving you a bit of added privacy around the house - plus, it's great for keeping the kids safe.

WOODEN GATES

From a simple round top or square top gate to a more traditional picket gate, Mitre 10 has a variety of gates on offer to suit the character of your home.

A range of widths and heights available

H3.2 treated radiata pine



ALUMINIUM GATES

We have a range of different sized aluminum gates available in store for both walkways and driveways.

These come in a variety of styles to match our range of aluminum fencing styles.

A range of widths and heights available.

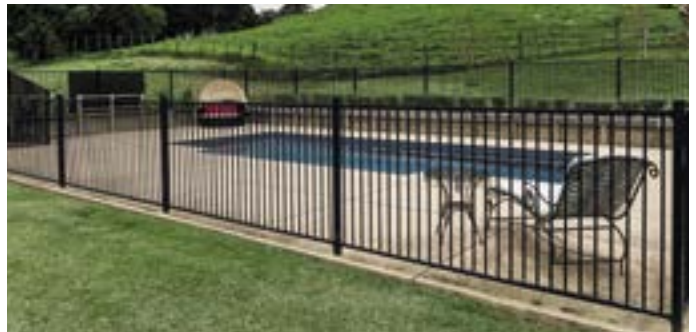

PICKET FENCING

Enhance your home's value in a timeless manner with a classic picket fence. With many profile options available such as the ever popular gothic picket or the colonial picket there will be a style to suit any home.

70 x 19mm

H3.2 treated radiata pine

Heights available are 900mm, 1, 1.2, 1.5m



Fence Stains & Paint

WATTYL FENCE FINISH

An easy to brush, water-based natural colour finish for rough sawn timber fences and trellis.



WATTYL FORESTWOOD TRADITIONAL OIL STAIN

An oil-rich penetrating stain that adds colour and protects whilst allowing the grain to show. Available in a range of popular timber colours. Ideal for smooth and rough sawn timber.



WATTYL SOLAGARD DECK & TIMBER PAINT

A tough and durable walk on exterior paint which offers protection for your home in any weather or climate. Provides exceptional protection from the elements without the need for a primer or undercoat on timber surfaces.



Trellis & Garden Screens

Garden screens and trellis are a great way to create extra privacy and also help to add design and character to your outdoor living space. Whether you are after Venetian, Diagonal, Oriental, Square, framed or unframed, Mitre 10 has a range of designs and sizes available.

At Mitre 10 we are proud to offer Genia Outdoor premium trellis and screening panels as well as our Number 8 value range of trellis.

- Number 8 trellis exclusive to Mitre 10
- Perfect screening to enhance your outdoor space
- H3.2 treated for outdoor application
- New Zealand made
- Stainless steel fasteners Genia range
- Galvanised fasteners Number 8 range

Genia
Outdoor Living

NUMBER 8
Good to Go

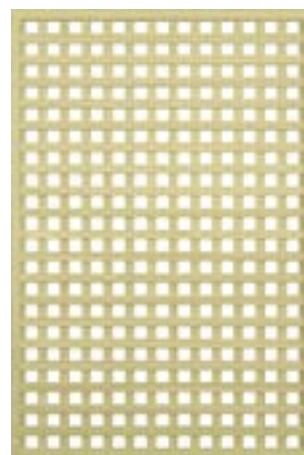

The SmartScreen range at Mitre 10 features New Zealand inspired and other decorative designs, all crafted with a variety of finishes - including woodgrain, cedar wood and more.



Timber Retaining Wall

Building a retaining wall can help you create a useable space in your garden. It can help you level up an area in your yard, or help protect against erosion. Building one isn't hard and done right, it'll last for ages.



TG&V TIMBER

- Interlocking timber ideal for a retaining wall or other landscaping project.
- Sizes available are 150x50mm, 200x50mm.
- H4 treated radiata

N2 ROUGH SAWN TIMBER

- Great for general construction such as building a retaining wall as well as being suitable for most landscaping projects.
- Sizes available are 150x50mm, 200x50mm.
- H4 treated radiata



Get all the help you need to build your retaining wall, online at mitre10.co.nz/easyas.

We have a helpful step-by-step guide that includes a list of everything you will need to get the project done.

Having the right tools for the job will help ease the workload and at Mitre 10 we have just what you need.

POST HOLE BORER

For jobs involving fence posts, poles and tree planting, a robust and durable post hole borer will help save you time and effort.



DRIVER DRILL

A cordless driver drill is ideal for working on big outdoor projects away from electrical outlets.



CIRCULAR SAW

Number one tool that can tackle a wide range of cutting tasks.



CONCRETE MIXER

Ideal for mixing concrete on small-to medium-size projects. The tipping wheel allows for pouring and filling barrows.



Build it better with
BREMICK

BREMICK BOLTS AND COACH SCREWS

We have a full range of Bremick bolts and coach screws available for all landscaping applications. Great for fixing metal to timber, timber to timber, or timber to masonry or concrete. They are designed to hold heavy loads firmly in place and are available in galvanised or stainless steel to stand up to New Zealand's weather elements.



Handy hints

For retaining walls 1m or higher, the New Zealand Building Code may require a safety barrier at the top. In residential housing this is likely to be required where the wall is beside an access path to the house. Before you start digging, check with your location of pipes and cables. You don't want to hit anything you shouldn't.

Block Retaining Wall

With our large range of concrete retaining walls, your outdoor living design possibilities are endless. Elegant designs and exceptional performance make block retaining walls perfect for any landscaping project, no matter how big or small.



FIRTH EZI WALL

Firth Ezi Wall® is one of the lightest segmental wall systems available. The interlocking systems makes for easy installation for the DIYer. Ezi-Wall® is suitable for low freestanding or retaining wall garden edging, up to 0.5m high, tree walls or even outdoor decorative features.



Rockface



Volcanic Ash



Onyx

FIRTH COMPAC®

Keystone Compac® features unrivalled aesthetic options and proven wall performance. Installers prefer the Compac® lighter weight making it easy to handle. Trusted by architects, engineers and contractors around the world, the Keystone Compac® unit utilises the proven Keystone pin connection system.

Although Keystone Compac® is capable of commercial applications, the large and rugged units are also popular in DIY retaining walls up to 1m. 11 units per m2.



Rockface



Onyx



Concrete

Concrete is one of the most versatile materials available for enhancing outdoor spaces because it offers unlimited design flexibility in terms of shape, colour and texture. Whether you're creating a pathway, garden feature, edging or retaining wall, we can help you get the right product for the job.



Mitre 10 has a range of pre-mixed concrete available for different applications.

CONCRETE FOR TIMBER RETAINING WALLS

When building a retaining wall it is important to have the right strength concrete for the job. For a retaining wall that is up to 1.2m in height we recommend using a MPa of at least 17.5 for timber posts.

GENERAL PURPOSE CONCRETE

Drymix Easy to Mix concrete is a general purpose concrete that is easy to work with. This achieves a 28-day comprehensive strength of 20MPa and is ideal for applications around poles, posts and pathways.

FAST SET CONCRETE

Drymix quick to set concrete is a great fast set concrete solution that sets in minutes. This is ideal for the placement of posts, clotheslines, and mail boxes.

HIGH STRENGTH CONCRETE

Drymix Hi-Strength 36 concrete is easy to work with and provides the strength required for structural applications. When mixed according to instructions it will exceed a 28 day compressive strength of 36 MPa. This is best suited for steps, patios, driveways, footings and corner posts



Go to mitre10.co.nz/easyas to find out **How to Use Concrete**.

Landscape Stones

Add stylish and practical touches to your outdoor space with our range of bagged landscaping stones. The Garden Highlights range includes decorative stones, pebbles, and sands perfect for adding texture and interest to your garden. All products are sourced here in New Zealand.



SCORIA

This is an attractive deep-red Scoria stone from Taupo. Used as a ground cover on gardens or as pot toppers. Use under a BBQ grill to maintain an even charcoal heat that enhances flavours. Can also be used to improve garden drainage.



DECORATIVE FLAT STONE

These decorative stones are an attractive light grey colour. Ideal for use in pathways, gardens, or display areas as a practical design element.



COARSE IVORY STONE

This coarse pebble can be used as a decorative ground cover or pot topper. This is an easy care and low maintenance product and is great to highlight special areas.



RIVERSTONE - MEDIUM

An alternative to bark as ground cover on gardens. Excellent in water features as well. Also used as a pot topper. Coarse Riverstone is a smooth, grey river pebble which is long-lasting and hard-wearing.



PUMICE - COARSE

A washed, screened and graded Pumice produced as a by-product of sand processing onsite in Matamata. This product is predominantly used in potting mixes, to open the mix up and achieve a desirable air filled porosity and provide good drainage.



LIME CHIP - COARSE

A hard white marble chip available in two grades. It is a hard-wearing, long-lasting product. A great alternative to bark as ground cover on gardens or as pot toppers, pathways, driveways and highlighting specific areas in the garden.

Edging Systems

Creating garden edging and borders with sleepers is one of the easiest ways to add character, define spaces and keep your garden looking tidy. Sleepers are a solid raised option that adds strong definition to any garden.

The SureWall edging and retaining system is a slide-together system for the creative DIYer. It is quick and easy to install while producing a heavy duty and robust end result. A great solution to create your own raised gardens, paths, or install a trampoline in-ground.



Permeable Paving

Permeable paving works great with decorative aggregates, to maintain a polished look. We have a great range of robust permeable paving options available to suit your design and use requirements.

SMARTPAVE

A heavy-duty pebble, gravel and grass reinforcement paver used to create a solid yet permeable surface. SmartPave can also be used in areas that take heavy load such as driveways. Made from 100% recycled materials and 100% recyclable.



SUREPAVE

A great way to stabilize your path, patio, courtyard and driveway stones and pebbles. The advanced honeycomb design ensures panels stay buried, preventing stones moving while creating a flat, firm pavement. Made from 100% recycled materials and 100% recyclable.



Sleeper Garden Edging

Creating garden edging and borders with sleepers is one of the easiest ways to add character, define spaces and keep your garden looking tidy. Sleepers are a solid raised option that adds strong definition to any garden.



Go to mitre10.co.nz/easyas to see **How to Create Wooden Garden Borders**

Sleepers are great for non structural landscaping projects such as garden edging, steps, raised gardens or planter boxes and low retaining walls.

MACROCARPA SLEEPER

A naturally durable sleeper that is easy to install and suitable for a wide range of landscaping applications.

- 200x100mmx2.1m



COLOUR INFUSED MCA SLEEPER

Micronized Copper Azole (MCA) is an environmentally friendly treatment that has a 50 year durability. These sleepers are colour infused at the time of treatment with a rich mahogany colour to complement any gardenscape.

- Sizes available are 200x100x2.4m and 200x75mmx2.4m
- H4 treated radiata



Handy hints

Always wear gloves when handling sleepers. Use a breathing mask when cutting sleepers. Creosote sleepers should not be used in areas where they will come into contact with food unless a suitable barrier is used.



Hedges

Hedges are very common in New Zealand gardens. They're a great living alternative to fences or borders, and they can also be used decoratively. Choose the right variety for your purposes.



Go to mitre10.co.nz/easyas to see **How to Grow Hedges**



CAMELLIAS

Camellias are very tolerant to a wide range of New Zealand conditions and are fast growing, which make them a popular hedging choice. Camellias serve as an attractive evergreen foliage and deliver beautiful floral displays with a range of flower forms and colours. Japonica and sasanqua are some of the most popular Camellia varieties used for hedging.



WESTRINGIA

Westringia suit a wide variety of uses ranging from expansive groundcover, to colourful formal hedges, box gardens, retaining walls or as an ornamental shrub. The flowers are attractive for bees and small birds for the overall health of your garden.



Quick growing evergreen shrubs and small trees to provide a green screen.

- Kowhai (Sophora)
- Griselinia varieties
- Pittosporum varieties
- Camellias
- Photinias
- Olives
- Buxus



Handy hints

Prune back your hedge up to a third at least once a year, this will help them become bushy. You should do this even if you want a tall hedge as it helps to stop gaps forming. Trim 3 - 4 times per year. When trimming your hedge, have the base of the hedge slightly wider than the top to ensure natural light can filter to the base foliage to retain growth of the foliage.

Planting Beds

Choosing plants is one of the most important steps in any new garden design or garden transformation. Which plants you choose for your garden will depend on many factors, from the orientation of your garden to its size and soil type, as well as your own preferences.

FLOWERING ANNUALS

Create instant colour in your garden. Seasonal colour comes in a wide range of varieties and can be a very economical way to transform the look of your garden. Generally these plants are flowering annuals so they'll only last one season, but that's what's great. Standard garden rules apply – start by getting the foundation. With a garden bed, make sure it is good healthy soil by preparing the bed with compost, sheep pellets and blood and bone.

Popular Varieties:

Petunias, Impatiens, Pansies, Marigolds, Violas, Nemesias, Alyssum, Salvias, Snapdragons and much more.



PERENNIALS

Perennials are classed as plants that live for more than two years. Flowering perennials add colour to your garden through every season, from Hellebores, Heucheras and Ligularia in the Autumn/Winter months to Geraniums, Daisies and Lavender in the Spring/Summer months. Your local Mitre10 store will be able to help you find plants to suit your individual garden style and environment and then you can enjoy the results.

Popular Autumn/Winter varieties:

Hellebores, Heucheras and Ligularia.

Popular Spring/ Summer Varieties:

Geraniums, Dianthus, Daisies, Lavenders & Osteospermums.



LAVENDER

Lavender is easy to grow, it lasts for years and smells great. It's a real favourite in New Zealand gardens. Lavender brings colour, beneficial insects to your garden, and repels pest insects. It's great as a border, hedge or in a garden bed.

Popular Varieties:

Major, Romance, Ruffles, Sensation, The Princess and Fairy Wings.

Go to mitre10.co.nz/easyas to see **How to Grow Lavender**



Native Trees

We have some amazing native trees in New Zealand each with their own special features, that help our environment, bring beauty to our gardens and landscapes, and provide shelter and food for birds and wildlife.

NATIVE TREES

New Zealand natives are unique and delight with stunning colours, distinctive leaf shapes and wonderful flowers that make them a stand-out in any garden large or small. Natives are perfect for our local environment and weather conditions, they are hardy, low maintenance and easy to care for. Natives are a popular choice for hedging, borders, or as landscape features.



Climbing Plants

Climbing plants are perfect for adding colour and texture to your garden, but they also provide additional shade when grown on a pergola. Chinese Star Jasmine, Clematis, Grape Vine, Wisteria, Bougainvillea, Hardenbergia, Pandorea and Climbing Roses are some of the top choices for a botanical shade that will turn your pergola into a beautiful focal point.

CHINESE STAR JASMINE

A versatile and easy to grow evergreen plant. Star Jasmine can be grown as a climber or as a creeper to create a compact, flowering, ground cover. Fragrant, star-shaped, white flowers spring and summer. Ideal for patio with a small trellis, climber to cover or as a groundcover.



Handy hints

Guiding climbers start at a young age. During its early stages, vines may require assistance to establish a firm grip on a pergola. Keep the stem securely fastened to the structure by pinning it down with a garden twine or tying it with a fabric tie. Consider using nylon stockings too as their stretchable materials give more room for vines to develop and expand.

10 POPULAR CLIMBERS FOR YOUR GARDEN

1. **TRACHELOSPERMUM JASMININOIDES** - Commonly known as Chinese Star Jasmine, this is a versatile and easy to grow evergreen plant with a star-shaped white flower and a delightful fragrance.
2. **MANDEVILLA ALOHA** - These versatile climbing plants flower abundantly in the warmer months with a stunning range of flower colours from red through pink to white.
3. **BOUGAINVILLEA SCARLET OHARA** - An ideal climber for over fences and pergolas. It thrives in warm, sunny, and well drained areas. This Bougainvillea gives a charming display of masses of deep red flowers.
4. **PANDOREA JASMINOIDES ROSEA** - Commonly known as Bower of Beauty or Bower Vine. An evergreen climber that produces pink trumpet flowers highlighted with magenta centres. It needs a strong archway, pergola or trellis to climb upon.
5. **PANDOREA JASMINOIDES LADY DI** - This is a good option for a sheltered position in full sun. This vigorous evergreen climber grows quickly and produces trumpet shaped pure white flowers.
6. **SOLANUM JAS GRANDIFLORA** - Also known as Potato Vine. This is a great climber to use for quick privacy, it is easy to care for and has prolific flowering over much of the year.
7. **HYDRANGEA SEEMANII** - A hardy evergreen climber with lush green leaves and frothy white flowers in the summer months. A good climber to cover fences, trellis or shady walls.
8. **CLEMATIS PANICULATA** - Also known as Puawananga, this native clematis grows well throughout New Zealand. It is an evergreen climber and has masses of white flowers in Spring and feathery seed heads.
9. **CLEMATIS HYBRID** - A vigorous and versatile climber that grows well over trellis and pergolas and gives a stunning display of huge star-shaped flowers. Available in a wide range of colours.
10. **HARDENBERGIA ALBA** - An evergreen climber with soft "pea-like" white flowers. It enjoys a sunny, well drained spot with protection from harsh frost.

Edible Garden

Nothing beats the taste of fresh veges and herbs straight from the garden. With your own vegetable garden, you can grow exactly what you want, and you'll know exactly what you're eating, where they've come from, and that they're free of nasty pesticides.

HERBS IN THE GARDEN

Herbs can be planted at any time of the year – but some can be seasonal. Plant somewhere with lots of light, and in a place that doesn't get too wet. Herbs make great companions for specific vegetables. Plus, they can help protect against insects, improve growth, and give a better flavour at harvest time.

Go to mitre10.co.nz/easyas to see **How to Grow Herbs**



SEASONAL VEGES

The best place to start is to find out what grows best at the time of year you're planting. Check out our Vegetable Planting Guide. The vegetable selection available at your local Mitre 10 store will not only be the best seasonal selection for planting, but also ideal for your region.

SOFT BERRIES

There are lots of different berries that are easy to grow and extremely tasty. Many berries are rich in vitamins, antioxidants, and other nutrients. Berries like a free-draining soil enriched with plenty of compost, and deeply mulched. Choose from a wide selection of assorted varieties of raspberries, strawberries, blueberries, blackberries and much more.

Go to mitre10.co.nz/easyas to see **How to Grow Raspberries**



PIP & STONE FRUIT TREES

Fruit trees are best planted in winter, when the plant is dormant, although they can still be planted any time until the end of spring. They need an open, warm, well-drained location with full sun for most of the day – this is really important for sweet ripe fruit. There's a huge variety of fruit trees you can grow at home. Apples, peaches, nectarines, plums, pears, apricots – the choice is yours. Just make sure you're aware of the climate and conditions where you live to ensure your fruit will thrive. If you need advice on what kind of fruit tree will grow in your area – just ask one of the staff in our garden centres and they'll show you what's available.

Go to mitre10.co.nz/easyas to see **How to Grow Fruit Trees**

Get Growing

The foundation of a flourishing, successful garden is to make sure you get the base ingredients right. Growing media is what plants grow in, and selecting the right growing media for your plants is the key to a healthy, sustainable garden.



POTTING MIX

Potting mixes are designed to assist with plant growth - whether this be indoors or outdoors - and works best in pots, containers and hanging baskets. Many potting mixes include a blend of slow release fertiliser and a wetting agent (for example, SaturAid) to assist with long term growth and nutrients.

COMPOST

Compost is comprised of organic matter and provides a rich source of nutrients for your plants. It also helps to improve soil structure. Compost is usually used as a combination mixed with another form of growing media (i.e; a garden or potting mix).



SPECIALTY MIXES

There is also a variety of specialty mixes available that are specially formulated for specific types of plants. Examples include Garden Mixes, Tomato Mixes, Herb Mixes, Strawberry Mixes and even Indoor Potting Mixes. Each are designed to provide specific plants with the right nutrients for the best start. Mitre 10 have a wide range of specialty mixes available in-store and online.



ORGANIC MULCHES

Bark is usually used to cover the surface of soil around your plants. Often used as a decorative element, bark is also great for suppressing weed growth and to keep moisture and essential nutrients in the soil for healthy plant growth. Organic mulch is usually comprised of leaves, grass clippings, bark and straw.

Go to www.mitre10.co.nz/guides-and-advice/guide/garden-water-saving-tips

Lawn Care

Lawns are often the feature of many gardens and are a great addition to the home. A luscious lawn creates the feeling of space and is the ideal place for family fun and relaxation. We give you some handy hints to get your lawn sorted this season.

PREPARE & SOW

Sowing a lawn from seed is one of the most cost effective methods. There are a few different seed varieties to choose from depending on what you are after.

Coated lawn seed - coated in a fungicide, fertiliser and bird repellent for protection. Often takes slightly longer to germinate.

Uncoated lawn seed - a bare seed so germinates much quicker, although has no protection from birds or fungi.

We recommend applying a small layer of Tui Lawn Preparation Mix first to provide lawn seed with a base of essential nutrients and fertiliser to get it started.

Whether you want a tougher, more durable lawn for kids to play on, a lawn seed specially designed to germinate in shady areas, or a low maintenance lawn, there are a variety of seed blends available.

If you are patching up an existing lawn, check which lawn seed or grass blend is already there to ensure you have a matching lawn!



Smart Lawn Seed

The Kiwicare LawnPro Smart Lawn Seed contains an AquaGel Technology which contains a water-based coating to assist with moisture retention during seed germination and is suitable for sunny or shady areas. The 1 and 4kg packs come with built in spreaders which makes the even distribution of seed very easy.

'Superstrike' Lawn Seed

Tui's 'Superstrike' Lawn Seed varieties feature a unique treatment which encourages fast establishment of lawn seed, so you can see results in as little as seven days under ideal growing conditions.

PROTECT

Weeds can often grow even in the most manicured lawn. However, a well-maintained lawn will have fewer weeds than a neglected one.

Sometimes the best way to eradicate weeds is to cut them out with a sharp knife, however there are also a variety of selective and non-selective weedkillers available at Mitre 10. Whether it be a ready to use formula or a concentrated mix, the option is up to you. Visit your local Mitre 10 store for advice on the best weedkiller for your lawn.



MAINTAIN

Applying lawn fertiliser helps to make your new lawn stronger and healthier - and less vulnerable to weed growth. It's also important to fertilise existing lawns to continue promoting strong and healthy growth.

There are many forms of lawn fertilisers available. Granular fertilisers are often more cost effective and do not 'salt out' in cold weather. Alternative options are 'hose-on' fertilisers - which contain a ready to use formulation - and are simple and effective to use.



Handy hints

We recommend testing the pH level of your soil every couple of years. Lawn soil should be acidic (around 6-6.5 on the pH scale). If your lawn is too acidic, you may need to apply garden lime or dolomite and if it's too alkaline apply sulphate of ammonia.

Go to mitre10.co.nz/easys to see **How to Care for and Maintain Lawns**



DIGGING & TIDYING

It's essential to use the right tools for digging, tidying and planting. Whether you are wanting to scoop and shift materials such as sand and soil, break up existing soil, or do a bit of levelling and tidying up around the garden, Mitre 10 have a full range of spades, forks, shovels and rakes that are perfect for the job at hand.

Garden tools are available with a variety of handle and blade options too. Options include wooden, fibreglass and stainless steel handles, complemented with either a stainless steel or carbon steel blade. If you're unsure as to what might be right for you - visit us in-store and check out our range.

PRUNING & TRIMMING

Once the new garden really starts to flourish, keeping it well trimmed and maintained is a simple task - and helps to keep plants healthy and strong all year round.

If you're looking to trim new growth on hedges and shrubs that are thinner and softer, hedge shears with either straight or wavy blades (with a max cutting diameter of 10-24mm) are perfect for the job. Secateurs can also be used for softer branches and stems - ideal for rose pruning.

For much thicker branches, garden loppers have a max cutting diameter of 20-50mm and are available with either anvil (single blade for thicker branches) or bypass blades (for more delicate stems).

Mitre 10 also have a range of pole pruners with adjustable, telescopic handles for those branches that are a bit more difficult to reach.

SOIL CULTIVATION

Cultivators are designed to scratch the soil either prior to planting or around the plants while growing. Soil cultivation is also great for aerating garden beds, and can either be done using a garden hoe (best used for shallow cultivation or for weeding plants), or pronged cultivators (ideal for loosening and breaking up soil). There are also a variety of handle options (wooden or fibreglass) to suit your needs.

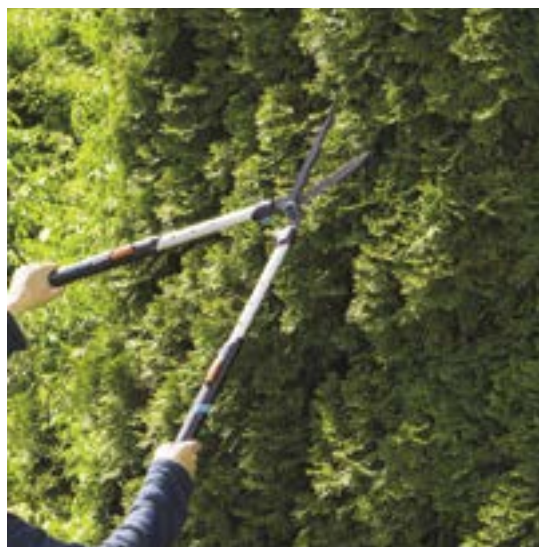

Makita Power Garden

The expanding LXT® System includes 18V and 36V lawn mowers, string trimmers, blowers, chain saws, brush cutters, pole saws and more. For pro landscapers and homeowners alike, this means more battery-powered options to replace petrol equipment for top performance with lower noise, less maintenance and zero emissions. With more than 60 solutions, LXT® is the world's largest professional cordless outdoor power equipment system powered by 18V lithium-ion slide-style batteries.



Makita is expanding the line of cordless OPE to include the 18V X2 LXT® Lithium-Ion (36V) 18" Lawn Mower. With zero emissions, lower noise and reduced maintenance, the 18V X2 (36V) Cordless Lawn Mower is a welcome solution for efficient grass cutting. It's powered by two 18V LXT batteries for maximum power and run time, but without leaving the 18V battery platform. The Makita-built motor delivers up to 3,300 RPM. The mower offers ease-of-use features including quick height adjustments, a 60L capacity grass collector, and folding handles for compact storage.



The 18V LXT® Brushless Cordless Couple Shaft Power Head is a welcome solution for a range of trimming and cutting applications. For maximum performance and run time without the hassles of petrol and without leaving the 18V battery platform.

The Power Head features a lever-style lock system for quick tool-less installation and replacement of attachments. It is compatible with a 14 varieties of attachments for trimming, edging, cultivating, and brush cutting and more (sold separately).



ADVANCED MOTORS

UP TO 50% MORE MOTOR LIFE

Makita-built brushless motors eliminate carbon brushes and run contact-free, enabling the motor to run cooler and more efficiently for longer life. The electronically controlled brushless motor efficiently uses energy to match torque and speed to the changing demands of the application.

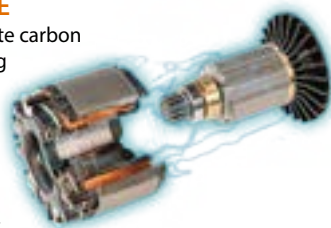

ENHANCED COMMUNICATIONS

EFFICIENT POWER MANAGEMENT

Star Protection Computer Controls™ is communication technology between the tool and battery that exchanges data in real-time to protect against overload, over-discharge and overheating.



ULTIMATE COMPATIBILITY

300+ PRODUCTS. LXT SYSTEM.

The LXT Battery delivers constant power and longer run time, even in extreme temperatures. The charger communicates with the battery's built-in chip to optimize battery life, controlling current, voltage, and temperature. A built-in fan circulates air through the battery during the charging process to cool the battery for faster charge time.



Irrigation

Ensuring your garden receives the right amount of water all year round can be tricky, so we recommend installing an irrigation system. We've got you covered with some handy hints and tips to get your irrigation system started.



WATERING THE GARDEN

Installing your own irrigation system takes all the hassle out of watering the garden and helps to prevent you from over or under watering. Irrigation systems are also effective in saving water.

IRRIGATION TOOLS



Pop-up sprayers: great for lawns and can have a variety of spray patterns to suit your garden. Ideal for medium-large watering areas.



Sprayers: usually used for garden beds and can either be directional or full 360 degree. They can also be height adjusted with risers. Ideal for small-medium watering areas.

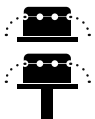

Drippers: great for garden beds, pots and containers. Ideal for delivering water slowly to the plant root or base.



AUTOMATED WATERING

Automating your irrigation system with timers lets you control how long and how often parts of your garden are watered.

Analogue: A tap mounted watering controller that can be manually set for a period of up to 120 minutes and will automatically switch off to help save water. Ideal for simplicity and is a low initial cost.

Digital: Also tap mounted but with a digital interface. Many new models automatically water at sunrise or sunset, or other customised, specific days and times.

WiFi: All the benefits of a digital watering controller, but programmed and controlled remotely from your smartphone.



Handy hints

Do a bucket test to determine your LPM (litres per minute). This will help to determine how many water lines and watering methods you may need: • Grab a 9L bucket • Turn your tap on full • Time how long it takes to fill the bucket • $(9\text{L bucket} \times 60 \text{ seconds in a minute}) / \text{time taken to fill} = \text{LPM}$

Go to mitre10.co.nz/easyas to see **How to Install Garden Irrigation**

Surface Drainage

New Zealand has a complex climate with most regions receiving between 600 and 1600mm of rainfall throughout the year. The winter months are also prone to heavy rain and torrential downpours which can leave lawns waterlogged and driveways flooded.



Left unchecked surface water can cause significant damage and issues to your property and surrounding environment. Installing drainage systems such as channel and grate and silt pits around your house, driveway and landscape areas is one way to prevent surface water accumulation.



Standard Plastic Grate



Pedestrian Plastic Grate



Galvanised Steel Grate



Stainless Steel Grate

SURFACE WATER DRAINAGE

Connecto Trade® is an interlocking modular surface water drainage system made from UV stabilised recycled materials. Designed in New Zealand for New Zealand's climate, Connecto Trade is the everyday solution for residential drainage projects. With a range of grate options Connecto Trade caters to the current and future housing designs of New Zealand.



DRAINFLO®

- Range – extensive range providing choice of diameter and length to suit your project
- NZ Made – Complete Drainflo range made right here in New Zealand
- 100% Recyclable – Drainflo is 100% recyclable and we can and do recycle and re-use it for new Drainflo
- Filtration – Custom-made filter sock options to prevent Drainflo clogging in sandy soil environments
- Flow – All new Drainflo Smooth range provides up to 50% greater flow rates helping to drain flat land



Rain Water Harvesting

Rain water is a free and renewing resource, giving you the freedom to use water as you wish, without restriction. Making the most of this free natural resource can also help you save money on your water rates. It can be relatively inexpensive to install a 250L water tank to gain continual benefits. In areas that there is year-round rain fall, a 250L tank is large enough to supply water for the garden.



COLLECTING AND UTILIZING RAIN WATER

There are many reasons to consider investing in a Rain Harvesting system for your home. Having your own system will allow you to enjoy:

- Improved drought resilience
- Alternative water supply during restrictions
- Cost savings associated with lower water bills
- Lower environmental footprint
- Added value to your property
- Increased self-sufficiency
- Enhanced building resilience

Rain water can be used for lots of different purposes like watering the garden, washing cars or filling up a spa pool.

HOW TO COLLECT RAINWATER

Collecting rainwater is as simple as collecting it from your roof and storing it in a tank until it is required.

A 250L tank with a hose connection and a tap is all you need for watering the garden and generally this system only relies on gravity so there is no need for a pump.

A leaf filter can be used to prevent most contamination.

Dark coloured tanks reduce light exposure to prevent algae growth.

Go to mitre10.co.nz/guides-and-advice/guide/how-to-install-a-water-tank



Handy hints

Make sure you disconnect your tank and screw on the cap provided before you commence cleaning your gutter to prevent debris entering your tank water.

Sustainable Gardening

Sustainability in the garden is easy and does absolute wonders for the environment. Take a look at our top tips when it comes to home composting, sustainable gardening and improving the fertility of your soil.



Home composting is such a simple, effective way of recycling most of your organic household and garden waste, with the added benefits of enriching your garden's soil at the same time. There are a number of ways in which you can set up a composting system in your home - we've got the solution for you.

Go to mitre10.co.nz/guides-and-advice/guide/how-to-make-your-own-compost

TUMBLER COMPOST BINS

Ideal for a smaller back garden or courtyard and can easily be placed on concrete or pavers. The turn mechanism allows for natural aeration and speeds up decomposition. Tumbling composters keep organic waste off the ground which prevents access for rodents.



ROUND OR SQUARE COMPOST BINS

Available in a range of sizes and are resistant to weathering, general wear and tear, and made from recycled polypropylene. Compact, cost-effective and lightweight. Allows you to combine compost with your soil to encourage natural retaining nutrients.



WORM FARMS

Worm farming uses composting worms such as tiger worms or red worms to eat through a mixture of organic waste (such as food scraps and garden waste) to produce worm castings (composted material) and liquid fertiliser, which helps to nourish soil and provide your plants with essential nutrients.

HUNGRY BIN WORM FARM

The Hungry Bin Worm Farm is one of the most unique worm farms in the market and is proudly New Zealand designed. The unique shape of the bin creates a large surface area allowing all worms to access all the food scraps at the top, as worms are generally surface feeders. The handy tray at the bottom allows you to easily access the castings and liquid produced by the hungry bin, which can be added directly to your soil for healthy planting.



Go to mitre10.co.nz/guides-and-advice/guide/how-to-set-up-a-worm-farm



Got a project on? Mitre 10's got you sorted with hundreds of helpful guides available in-store or online at mitre10.co.nz/easyas



Check out our website for step-by-step instructions and Easy As videos to talk you through the project.



Download a shopping list



or grab one of the helpful guides from your local store



Planning is Key

Before you start landscaping your garden you need to consider a number of things. From the types of plants suitable for your garden to underground services that may restrict you from building larger structures, these all need to be factored in during your planning process.

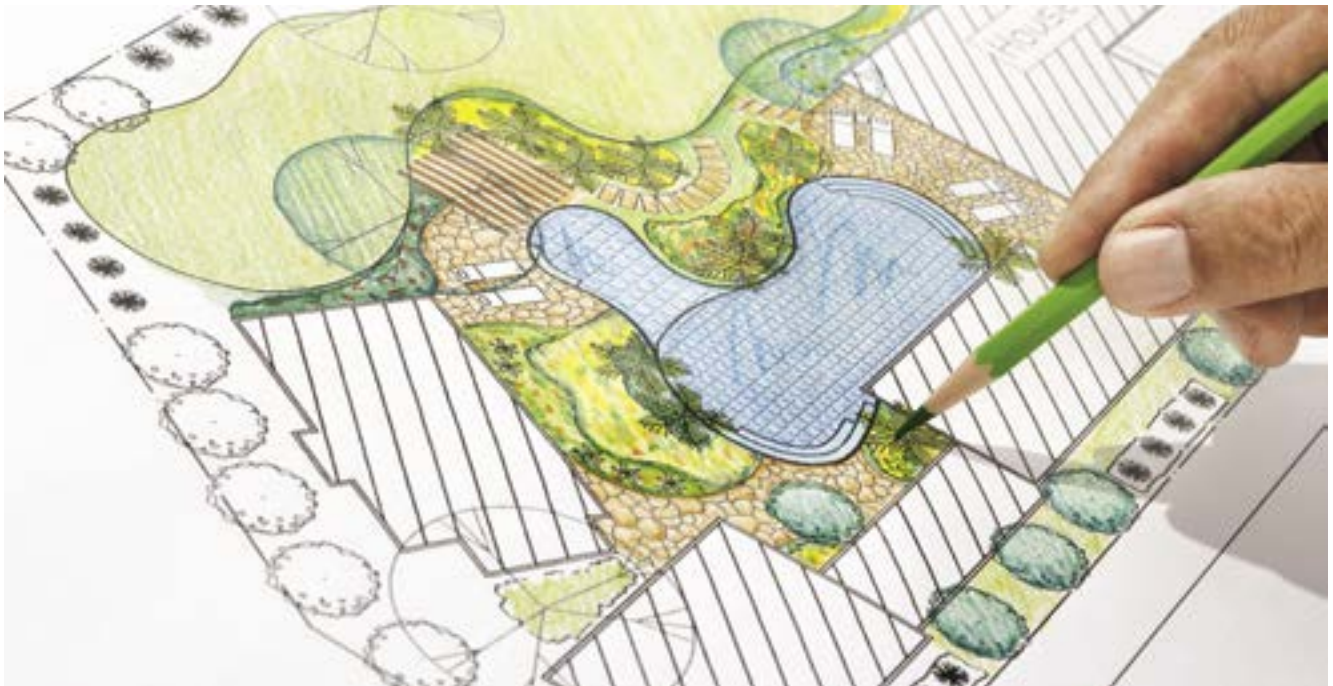

STEP 1: THE SCALE DRAWING

The first step to planning is to draw an accurate scale drawing of the site. This plan should show the site boundaries and features such as buildings, paths, driveways, paving, existing plants, exposed rocks or water sources, and underground services like water pipes and electrical cables. These are the elements around which the garden will need to be constructed.

STEP 2: MAKING BUBBLE DIAGRAMS

The next step is to make area divisions or “bubble diagrams” according to the anticipated use, and this is best done on tracing paper pinned over the site plan. Draw different-sized bubbles, corresponding to all the elements and space you need for each area. These bubbles would, for example, represent the lawn area, vegetable garden, decking or patio, entrance area and paving. Consider how you will move around in the garden when drawing the bubbles.

STEP 3: THE GRID SYSTEM

Once your bubble diagram has produced an acceptable arrangement, you can start designing the garden. Draw grid lines on a clean piece of tracing paper over the site plan, to help get proportions right. Gridlines should spring from the dominant lines in the site, like the corners of the house, windows and doors, as well as existing paving and patios. These lines can be drawn at an angle and the design worked on the diagonal. The grid size depends on the size of the site and how complicated the plan is.

STEP 4: THE GARDEN LAYOUT PLAN

Use another piece of tracing paper over your site plan and grid system. Based on your bubble diagram, draw patterns on the grid until you come up with a well-balanced design that incorporates all the desired elements. Although it is difficult, you will need to try to think in three dimensions.

YOUR NOTES

**Our trade
team are here
to help
you get the
job done right.**

We know the industry. We know trade. We've got over 80 dedicated trade departments nationwide with skilled industry trained reps to get what you need, when you need it. No mucking around.

mitre10.co.nz/trade

**MITRE 10
TRADE**

WITH YOU ALL THE WAY

