

# Nouveau®

## **Chrome Desk Fan 30cm**



This manual applies to the following products  
SKU: 361742 / Model: FT-30MC

# Nouveau.

## **Table of Contents**

Important Safety Instructions

Description of Parts

Assembly

Speed Selection

Oscillation

Angling the fan

Please read this manual carefully before use, and keep for further guidance

# Nouveau.

## **Important Safety Instructions**

This appliance can be used by children aged from 8 years and above if they have been given supervision or instruction concerning use of the appliance in a safe way and if they understand the hazards involved. Cleaning and user maintenance shall not be made by children unless they are aged from 8 years and above and supervised.

Keep the appliance and its cord out of reach of children aged less than 8 years.

Appliances can be used by persons with reduced physical, sensory or mental capabilities or lack of experience and knowledge if they have been given supervision or instruction concerning use of the appliance in a safe way and if they understand the hazards involved.

Children shall not play with the appliance.

If the supply cord is damaged, it must be replaced by the manufacturer, its service agent or similarly qualified persons in order to avoid a hazard.

**TO REDUCE THE RISK OF FIRE OR ELECTRICAL SHOCK, DO NOT USE THIS FAN WITH ANY SOLID-STATE SPEED CONTROL DEVICE.**

**UNPLUG OR DISCONNECT THIS FAN FROM THE POWER SUPPLY BEFORE SERVICING.**

When using electrical appliances, basic precautions should always be followed to reduce the risk of fire, electric shock, and injury to persons, including the following:

1. The appliance is for household and indoor use only.
2. Before plugging in, check that the voltage on the fan rating label is the same as the mains supply.
3. To protect against electric shock, do not immerse any part of the fan in water or other liquid.
4. This fan is intended for use by competent adults only and children should always be supervised.

# Nouveau.

5. It is recommended to unplug the fan from the mains socket when not in use.
6. Always remove from the mains socket before cleaning.
7. The supply cable cannot be replaced. If the cable is damaged the appliance should be scrapped.
8. Do not let the cable hang over the end of a table or work surface or touch hot surfaces.
9. Do not use the appliance for other than its intended use.
10. If the supply cord is damaged, it must be replaced by the manufacturer, its service agent or similarly qualified persons in order to avoid a hazard.
11. Ensure that the fan is switched off from the supply mains before removing the guard.
12. Don't use this fan in the immediate surroundings of a bath, a shower or a swimming pool. Never locate the fan where it may fall into the bathtub or other water container.

# Nouveau.

## Description of Parts

- 1 Safety Grilles (front and rear)
- 2 Fan Blades
- 3 Oscillation Knob -- push down to activate right/left oscillation mode; pull up to stop oscillation
- 4 Motor Housing
- 5 Speed Control knob -- select speed settings: Off=0, Low=I, Medium=II, High=III
- 6 Base

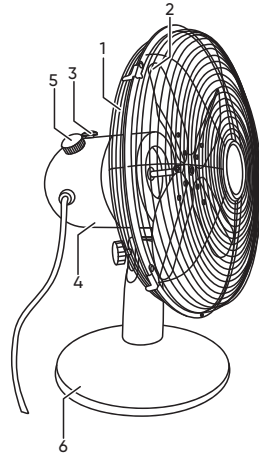

## Assembly

Your new fan has been shipped partially assembled to reduce wastage of packaging material, paper cartons and weight. Follow the instructions below to assemble it; the illustration opposite shows how all the parts fit together.

- Remove the protective sleeve (if any) from the motor shaft.
- Remove the four rear guard retaining screws from the motor housing.
- Attach the rear guard to the motor housing using the four screws you just removed. Make sure the handle is at the top. Tighten the screws securely using a Phillips head screwdriver.
- Locate the flat on the spindle (marked in the drawing) and turn the spindle so this faces upwards.
- The fan blade fixing screw will tighten onto this face

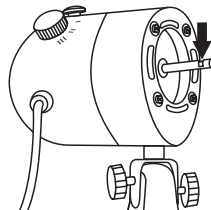

- Place the fan blades onto the spindle with the screw on the fan shaft facing upwards.

# Nouveau.

- The tip of the screw must rest on the flat on the drive shaft.
- Align the fan with the end of the motor spindle (arrowed), then use a long screwdriver to tighten the fixing screw onto the shaft.

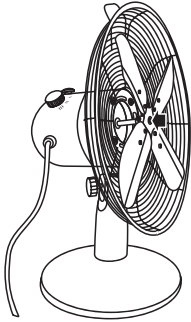

- Remove the grille rim screw and nut from the front guard and open the clips around the outside edge of the front grille, turning them outwards.
- Hang the front grille by its hook over the top of the rear guard, making sure the holes for the rim screw and nuts are aligned. Bring the front guard down to meet the rear guard and push the clips inwards until the front guard is fastened to the rear guard. Finally fit the grille rim screw and nut through the holes in the bottom edge of the guard and tighten with a screwdriver.

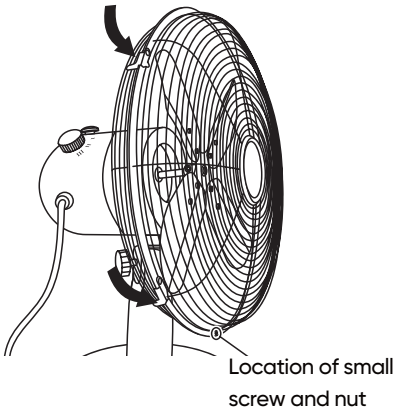

# Nouveau.

- 1 Front guard (grille)
- 2 Blade
- 3 Rear guard (grille)
- 4 Grille rim screw
- 5 Grille rim nut
- 6 Rear guard retaining screws (4)
- 7 Speed control knob
- 8 Oscillation knob
- 9 Motor
- 10 Power cord
- 11 Lock nuts for angle adjustment
- 12 Body
- 13 Base

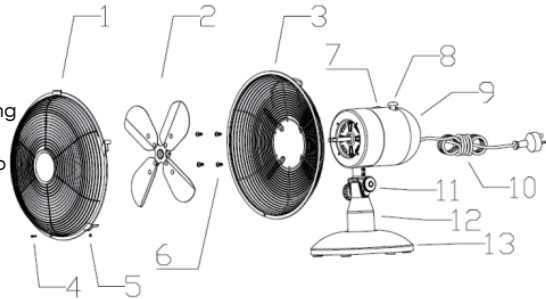

## Speed Selection

The power switch is incorporated in the Speed control knob at the top of the fan's motor housing.

Turn the switch clockwise from the OFF [ 0 ] position to the desired speed setting for low, medium or high speed. 0 .....OFF

I .....LOW

II .....MEDIUM

III .....HIGH

## Oscillation

To allow the fan to oscillate, push down the oscillation knob on top of the motor housing. The fan head will pivot from one side to the other. Pull up the knob when the fan is in the correct position and oscillation is not desired.

## Angling the fan

The head of the fan can be adjusted up or down if required.

- Disconnect the fan from mains power.
- Slacken the two angle adjustment lock nuts slightly.
- Set the tilt angle of the fan as you want it.
- Tighten the angle adjustment lock screws to fix the fan at this angle.

# Nouveau.



**You can help protect the environment!**

Please remember to respect the local regulations: hand in the non-working electrical equipments to an appropriate waste disposal centre.

MADE IN CHINA